



THE SWISS ARMY KNIFE OF GOOSENECK TRAILERS

This Rōm 500G is available as a base unit that can be enhanced with a host of options, or it can be ordered with the fully loaded Plus Package. All Rōm 500G trailers are ready to roll and configured so that it's easy to add an optional bathroom, kitchenette, cabinet packages, generator doors, awnings and much more. These stylish Rōm trailers are engineered to safely and efficiently haul your prized possessions wherever the road takes you. **Details at [ATCtrailers.com](https://www.atctrailers.com)**

KEY STANDARD FEATURES:

- Full perimeter aluminum frame with all-tube aluminum construction
- Polished cast corners and stainless steel front radius trim
- Prepped to add bathroom package or many other popular options
- Spread axle design for better towing
- With or without a Premium Escape Door
- Base unit or fully loaded Plus unit available

BASE MODEL

8.5' x 36' Gooseneck w/ (2) 7,000# Torsion Axles

8.5' x 40' Gooseneck w/ (2) 7,000# Torsion Axles

8.5' x 44' Gooseneck w/ (3) 7,000# Torsion Axles

COLORS

Exterior



Polar White



Black



Silver Frost



Medium Charcoal

STANDARD FEATURES

Frame

Full Perimeter Aluminum Frame
 All-tube Aluminum Construction
 2-5/16" 25,000# GN Coupler
 Manual Single Speed Jacks
 Spread Axle Design
 Torsion Axles
 Electric Brakes – All Axles
 ST235/85R16/LRG – Radial on Aluminum Wheel
 16" O/C Floor, Roof, & Wall Crossmembers
 7-Way Truck Plug
 Rear Skid Plates
 48" Beavertail
 Winch Plate

Interior

7.5' Interior Height
 3/4" Plywood Floor, Ramp, & Bunk
 Open Stud Walls and Ceiling
 (4) 5,000# Recessed D-Rings

Exterior

.040 Exterior Aluminum – Screwless
 ATP Stoneguard
 One Piece Aluminum Roof
 4" Upper and Lower Trim
 Polished Cast Corners
 Stainless Steel Front Verticals & Top Radius
 Rear Ramp Door w/ Trans Flap – 4,000# Rated
 Aluminum Bar Locks
 48" Entrance Door w/ Slam Latch
 (2) 14" x 14" Manual Roof Vents
 LED Clearance Lights
 (1) Pair Slimline Tail Lights
 Side Mount Turn Signals
 Rear Spoiler

Electrical

(3) LED Dome Lights w/ Wall Switch

CHOOSE ANY COMBINATION OF PACKAGES

Premium Escape Door Package

- Removable Interior Wheel Well
- Integrated Step
- Premium Escape Door

Black Trim Package

- Black ATP Gravel Guard
- Black Upper & Lower Trims
- Black Exterior Fasteners on Trim
- Black Fenders
- Black Wheels
- Black Exterior Door Trim
- Black Grab Handles & Bar Locks
- Black Logos
- Black Cast Corners and Top Radius and Verticals

Plus Package

- Rear Bogey Wheels
- Dual Hydraulic Jacks
- Brace and Wire for A/C Prep
- Full Perimeter Skirt w/ Polished Fenderettes
- 7" Lower Trim
- (2) 36" x 24" Exterior Riser Access Doors
- Stainless Steel Rear Header and Verticals
- Stainless Steel Rear Paddle Locks
- Slide In Slide Out Step
- Mid Ship Side Mount Turn Signals
- (2) Pair Slimline Taillights
- Rear Spoiler – w/ (3) LED Lights
- (2) 12v Roof Vents w/ Switch
- White Aluminum Walls and Ceiling – Screwless
- Black Cove Molding and Spring Box Cover
- Wall and Ceiling Insulation – R3
- Black Coin TPO Floor, Ramp, & Transition Flap
- Carpet in Bunk
- 50 Amp Breaker Box w/ 60 Amp Converter and 12v Fuse Panel
- Breaker Box Wall Cabinet – No Storage
- Motorbase Plug w/ 25' Shore Cord
- (3) 15 Amp Interior Outlets
- (1) 15 Amp Exterior Outlet
- (5) 49" Cove Strip Lights – (7) on 44' Model
- 12v AGM Battery
- 12v Cut-off Switch
- (2) Exterior Scene Lights – LED

POPULAR Rōm 500G ADDITIONAL OPTIONS

	Base	Plus		Base	Plus
Rear Bogey Wheels	Option	Std	In Floor Winch Box (No Winch Included)	Option	Option
Single Hydraulic Jack	Option	N/A	In Floor Winch Box w/ 5,000# Winch	Option	Option
15,000 BTU AC w/ Manual Controls	Option	Option	In Floor Storage Box	Option	Option
15,000 BTU AC w/ Thermostat	Option	Option	In Floor Spare Tire Compartment (No Spare Included)	Option	Option
36" x 24" Exterior Riser Access Doors	Option	Std	In Floor Spare Tire Compartment w/ Aluminum Spare Tire	Option	Option
Slide In/Out Step	Option	Std	Spare Tire Mount w/ Aluminum Spare Tire	Option	Option
White Aluminum Walls & Ceiling – Screwless	Option	Std	12V Awning w/ LED Lights – 20' LCI	Option	Option
3/8" Engineered Wood Walls	Option	N/A	Salem Vents (Pair)	Option	Option
Wall & Ceiling Insulation	Option	Std	Airline Track – Surface Mounted – Floor	Option	Option
Black Coin Flooring, Ramp, & Transition Flap	Option	Std	Airline Track – Recessed – Floor	Option	Option
Grey Coin Flooring, Ramp, & Transition Flap	Option	N/A	Upper Cabinets	Option	Option
Carpet Floor In Bunk	Option	Std	Lower Cabinet Packages	Option	Option
40"H Bedrug On Walls	Option	Option	Generator Compartment w/ 42" x 36" Generator Door	Option	Option
Electrical Package	Option	Std	4.0 KW Generator w/ 24 Gallon Fuel Tank & Fuel Door	Option	Option
(2) Exterior Scene Lights	Option	Std	5.5 KW Generator w/ 24 Gallon Fuel Tank & Fuel Door	Option	Option
Half Bathroom Package – Sink & Stool	Option	Option	5.5 KW Generator w/ 36 Gallon Fuel Tank & Refuel Station	Option	Option
Half Bathroom Package w/ Kitchenette	Option	Option	36 Gallon Fuel Station w/ Fill Door	Option	Option
30" x 20" Frameless Egress Window	Option	Option	Fresh Water Tank – 48 Gallons w/ Water Pump & Spigot	Option	Option

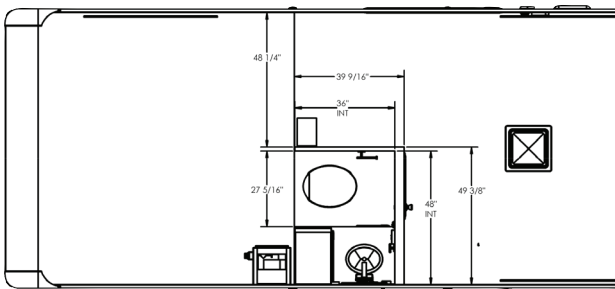

Half Bathroom Package – Sink and Stool

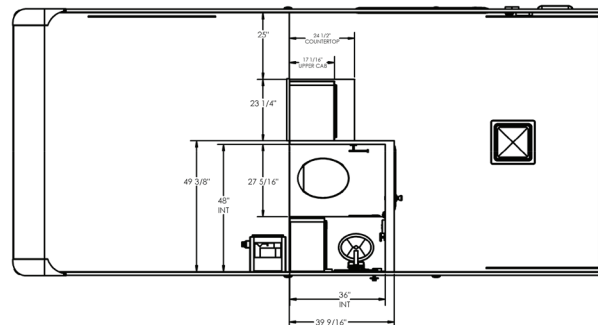

Half Bathroom w/ Kitchenette Package

The depictions of trailers in this brochure are for general information purposes only as to the trailers manufactured by ATC during the current model year. Since we continually strive to improve our products, actual products may differ and prices and specifications are subject to change without notice. Product information, specifications, photography, and promotions in this brochure may contain some features that are optional on your trailer. All capacities are approximate and dimensions are nominal. Trailer availability may be limited. ©2023 ATC Part #0024907 | 04-19-2023